

Bodenausgleichsschraube

Gruppe BOR

Material: PP

Standardfarben: schwarz

Farbcode: 760

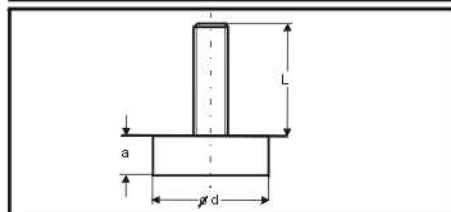

Bestell.-Nr.	Teller Ø	L	d	a	Preis pro 100 Stück bei Abnahme von							
					price per 100 pcs							
					500 St.		1.000 St.		5.000 St.		10.000 St.	
DM	EUR	DM	EUR	DM	EUR	DM	EUR					
4730820	30	M8 x 20	30,0	10,0	41,75	21,35	33,40	17,08	31,36	16,04	29,87	15,27
4730830	30	M8 x 30	30,0	10,0	45,68	23,36	36,54	18,68	34,31	17,54	32,68	16,71
4730840	30	M8 x 40	30,0	10,0	48,57	24,84	38,86	19,87	36,49	18,66	34,75	17,77
4730850	30	M8 x 50	30,0	10,0	50,28	25,71	40,22	20,57	37,77	19,31	35,97	18,39
4731020	30	M10 x 20	30,0	10,0	51,97	26,57	41,58	21,26	39,04	19,96	37,18	19,01
4731030	30	M10 x 30	30,0	10,0	54,03	27,62	43,22	22,10	40,58	20,75	38,65	19,76
4731040	30	M10 x 40	30,0	10,0	55,55	28,40	44,44	22,72	41,73	21,33	39,74	20,32
4731050	30	M10 x 50	30,0	10,0	57,76	29,53	46,21	23,62	43,39	22,18	41,32	21,13
4740820	40	M8 x 20	40,0	10,0	48,22	24,66	38,58	19,73	36,23	18,52	34,50	17,64
4740830	40	M8 x 30	40,0	10,0	51,97	26,57	41,58	21,26	39,04	19,96	37,18	19,01
4740840	40	M8 x 40	40,0	10,0	53,17	27,19	42,54	21,75	39,94	20,42	38,04	19,45
4740850	40	M8 x 50	40,0	10,0	57,25	29,27	45,80	23,42	43,01	21,99	40,96	20,94
4741020	40	M10 x 20	40,0	10,0	60,83	31,10	48,67	24,88	45,70	23,36	43,52	22,25
4741030	40	M10 x 30	40,0	10,0	66,12	33,80	52,89	27,04	49,67	25,39	47,30	24,18
4741040	40	M10 x 40	40,0	10,0	68,67	35,11	54,94	28,09	51,59	26,38	49,13	25,12
4741050	40	M10 x 50	40,0	10,0	72,60	37,12	58,08	29,70	54,54	27,88	51,94	26,56
4741230	40	M12 x 30	40,0	10,0	77,89	39,82	62,31	31,86	58,51	29,91	55,72	28,49
4741240	40	M12 x 40	40,0	10,0	80,96	41,39	64,77	33,12	60,82	31,09	57,92	29,61
4741250	40	M12 x 50	40,0	10,0	84,86	43,39	67,89	34,71	63,75	32,59	60,71	31,04
4751020	50	M10 x 20	50,0	11,5	77,89	39,82	62,31	31,86	58,51	29,91	55,72	28,49
4751030	50	M10 x 30	50,0	11,5	79,93	40,87	63,94	32,69	60,04	30,70	57,18	29,24
4751040	50	M10 x 40	50,0	11,5	84,53	43,22	67,62	34,57	63,49	32,46	60,47	30,92
4751050	50	M10 x 50	50,0	11,5	89,80	45,91	71,84	36,73	67,45	34,49	64,24	32,85
4751230	50	M12 x 30	50,0	11,5	97,47	49,84	77,98	39,87	73,22	37,44	69,73	35,65
4751240	50	M12 x 40	50,0	11,5	102,75	52,54	82,20	42,03	77,19	39,46	73,51	37,59
4751250	50	M12 x 50	50,0	11,5	106,33	54,37	85,07	43,49	79,87	40,84	76,07	38,89